

JOSH GREEN, M.D.  
GOVERNOR  
KE KIA'ĀINA



EDWIN H. SNIFFEN  
DIRECTOR  
KA LUNA HO'OKELE

Deputy Directors  
Nā Hope Luna Ho'okele  
DREANALEE K. KALILI  
TAMMY L. LEE  
ROBIN K. SHISHIDO

IN REPLY REFER TO:

**STATE OF HAWAII | KA MOKU'ĀINA 'O HAWAII'**  
**DEPARTMENT OF TRANSPORTATION | KA 'OIHANA ALAKAU**  
869 PUNCHBOWL STREET  
HONOLULU, HAWAII 96813-5097

Board of Land and  
Natural Resources  
State of Hawaii  
Honolulu, Hawaii

ISSUANCE OF A REVOCABLE PERMIT FOR OFFICE SPACE TO  
SUPPORT ITS SUSTAINABILITY CONTRACT FOR STATE AIRPORTS  
SUSTAINABILITY PARTNERS, LLC  
DANIEL K. INOUE INTERNATIONAL AIRPORT  
TAX MAP KEY: (1) 1-1-003: 058 (PORTION)

OAHU

APPLICANT:

Sustainability Partners, LLC, whose business address is 3133 West Frye Road, Suite 101  
Chandler, Arizona 85226.

LEGAL REFERENCE:

Hawaii Revised Statutes (HRS), Section 171-55, as amended.

LOCATION AND TAX MAP KEY:

Portion of Building 344, Ewa Extension Domestic Building, Second Level at  
Daniel K. Inouye International Airport (Airport), Island of Oahu, State of Hawaii,  
identified by Tax Map Key: 1<sup>st</sup> Division, 1-1-003: 058 (Portion).

AREAS:

Bldg/Room No. 344-275A, containing an area of approximately 444 square feet,  
as shown and delineated on the attached map labeled Exhibit "A".

ZONING:

State Land Use District: Urban  
City and County of Honolulu LUO: Industrial (I-2)

**ITEM M-5**

BLNR – ISSUANCE OF A REVOCABLE PERMIT FOR OFFICE SPACE TO SUPPORT ITS  
SUSTAINABILITY CONTRACT FOR STATE AIRPORTS  
SUSTAINABILITY PARTNERS, LLC  
Page 2

LAND TITLE STATUS:

Non-Ceded - Section 5(a) lands of the Hawaii Admission Act  
DHHL 30% entitlement lands pursuant to Hawaii Admission Act YES \_\_\_\_ NO X

CURRENT USE STATUS:

Land presently encumbered by Governor's Executive Order No. 3201, dated June 8, 1983, setting aside 3,152.177 acres designated as the Airport under the control and management of the State of Hawaii, Department of Transportation (HDOT) for Airport Purposes.

CHARACTER OF USE:

Sustainability Partners, LLC will use the office space to support its sustainability contract to provide electric vehicles and install electric vehicle chargers at the Airport to meet the State of Hawaii's clean energy goals.

COMMENCEMENT DATE:

To be determined by the Director of Transportation at a later date.

MONTHLY RENTAL:

\$972.36 (based on an office rate of \$18.60 per square foot per annum, as determined from the HDOT schedule of rates and charges established by appraisal of Airport property statewide plus \$111.00 for air conditioning and \$173.16 for utilities).

SECURITY DEPOSIT:

\$2,917.08, or three times the monthly rental in effect.

DCCA VERIFICATION:

Place of business registration confirmed:	YES <u>X</u>	NO ____
Registered business name confirmed:	YES <u>X</u>	NO ____
Good standing confirmed:	YES <u>X</u>	NO ____

CHAPTER 343, HRS - ENVIRONMENTAL ASSESSMENT:

The environmental impacts of the proposed action to the subject land area are covered by the Honolulu International Airport, Airport Modernization Program Environmental Assessment (EA), State Project No. AO1030-13. The EA is a joint State and Federal document dated January 2013, and published in the February 8, 2013, issue of the OEQC

BLNR – ISSUANCE OF A REVOCABLE PERMIT FOR OFFICE SPACE TO SUPPORT ITS  
SUSTAINABILITY CONTRACT FOR STATE AIRPORTS  
SUSTAINABILITY PARTNERS, LLC  
Page 3

Bulletin. Accordingly, the actions have been determined to have little or no impact upon the environment.

REMARKS:

In accordance with HRS, relating to Permits, HDOT proposes to issue a month-to-month revocable permit to Sustainability Partners, LLC for office space to support its sustainability contract for State airports.

RECOMMENDATION:

Based on this submittal, and testimony and facts presented, the HDOT recommends the Board finds that approving the issuance of a month-to-month Revocable Permit to Sustainability Partners, LLC, including its conditions and rent, will best serve the interests of the State.

Respectfully submitted,



EDWIN H. SNIFFEN  
Director of Transportation

APPROVED FOR SUBMITTAL:



DAWN N. S. CHANG  
Chairperson  
Board of Land and Natural Resources

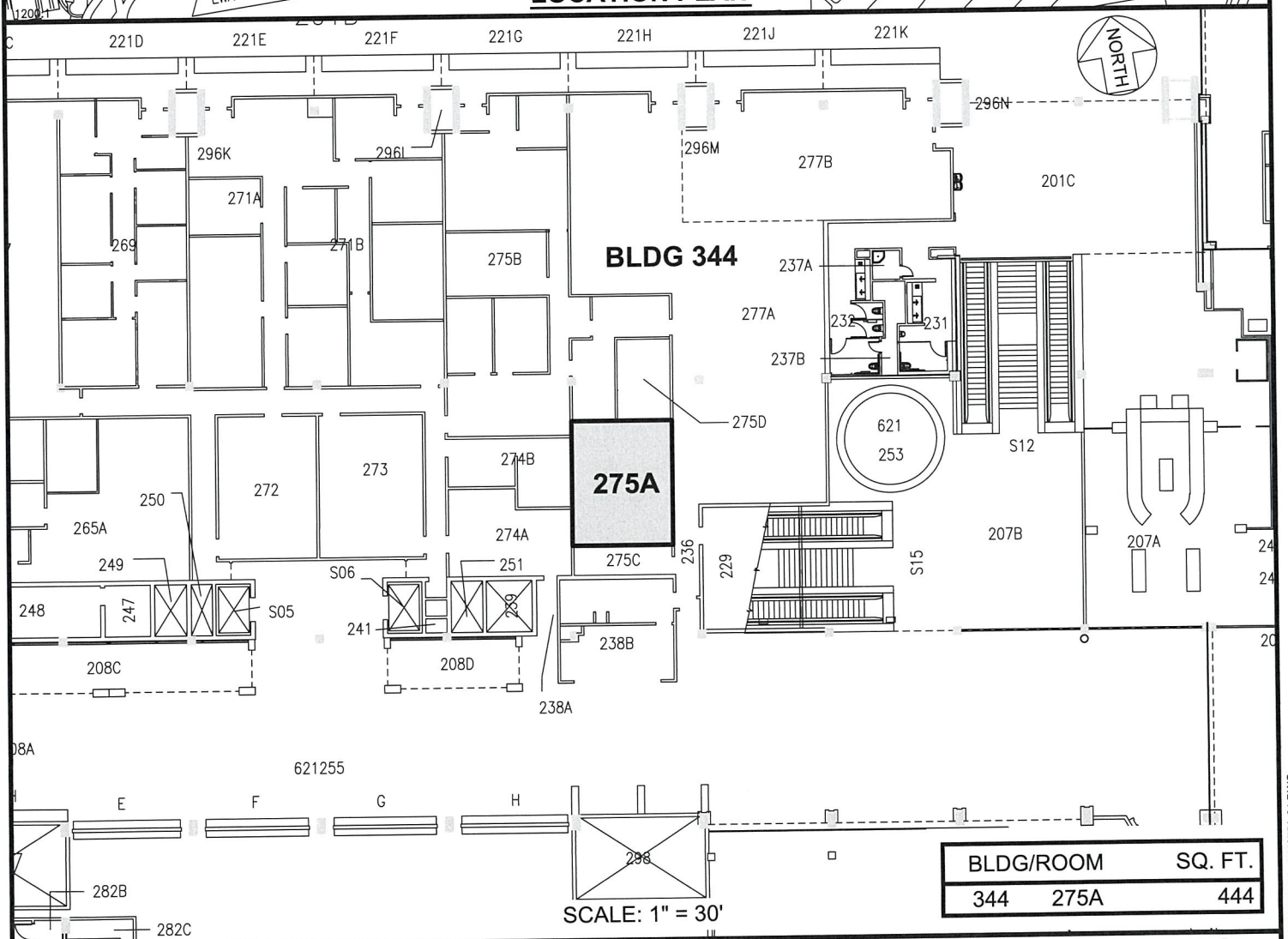
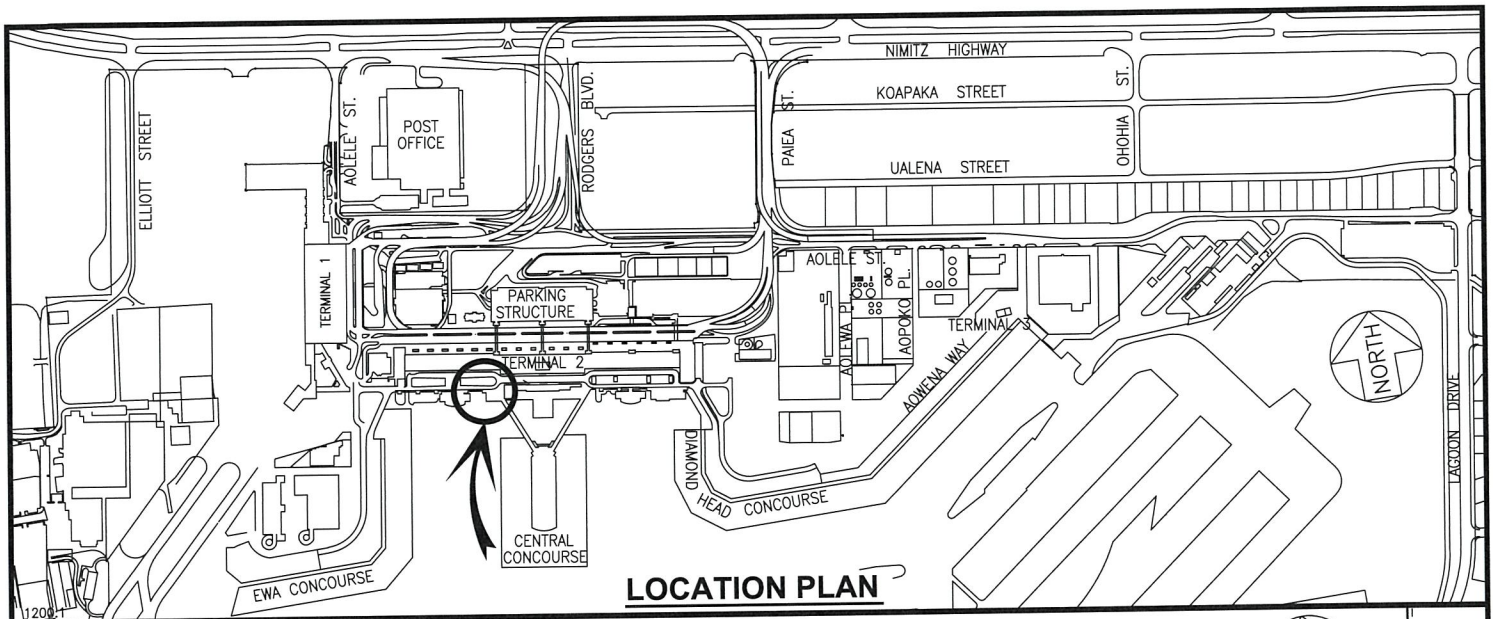

RP-9509

DATE : OCTOBER 2023

EXHIBIT: **A**



AIRPORTS

SUSTAINABILITY  
PARTNERS, LLC

BUILDING 344  
EWA EXT DOMESTIC BLDG  
SECOND LEVEL

344275A

DANIEL K. INOUE INTERNATIONAL AIRPORT

N:\AIRPORTS\HNL\_HONOLULU\CAD\PI\MHNL\_344275A-01.DWG