

JOSH GREEN, M.D.  
GOVERNOR



STATE OF HAWAII  
DEPARTMENT OF TRANSPORTATION  
869 PUNCHBOWL STREET  
HONOLULU, HAWAII 96813-5097

EDWIN H. SNIFFEN  
DIRECTOR

Deputy Directors  
DREANALEE K. KALILI  
TAMMY L. LEE  
ROBIN K. SHISHIDO  
JAMES KUNANE TOKIOKA

IN REPLY REFER TO:

Board of Land and  
Natural Resources  
State of Hawaii  
Honolulu, Hawaii

ISSUANCE OF A REVOCABLE PERMIT FOR THE INSTALLATION  
OF SIX (6) AVIGILON CAMERAS AT GATES E1, E3, E5, E6, E7 AND E9  
AS PART OF ITS AIRLINE OPERATIONS  
SOUTHWEST AIRLINES CO.  
DANIEL K. INOUE INTERNATIONAL AIRPORT  
TAX MAP KEY: (1) 1-1-003: 050 (PORTION)

OAHU

APPLICANT:

Southwest Airlines Co. (Southwest Airlines), whose business address is  
2702 Love Field Drive, Dallas, Texas 75235.

LEGAL REFERENCE:

Section 171-55, Hawaii Revised Statutes.

LOCATION AND TAX MAP KEY:

Building No. 350, Central Concourse, Ground Level at  
Daniel K. Inouye International Airport, Island of Oahu, State of Hawaii, identified by  
Tax Map Key: 1<sup>st</sup> Division, 1-1-003: 050 (Portion).

AREA:

Bldg/Room No. 350-175, containing an area of approximately one square foot;  
Bldg/Room No. 350-176, containing an area of approximately one square foot;  
Bldg/Room No. 350-177, containing an area of approximately one square foot;  
Bldg/Room No. 350-178, containing an area of approximately one square foot;  
Bldg/Room No. 350-179, containing an area of approximately one square foot; and  
Bldg/Room No. 350-180, containing an area of approximately one square foot,  
as shown and delineated on the attached map labeled Exhibit "A".

**ITEM M-6**

BLNR – ISSUANCE OF A REVOCABLE PERMIT FOR THE INSTALLATION OF SIX (6) AVIGILON CAMERAS AT GATES E1, E3, E5, E6, E7 AND E9 AS PART OF ITS AIRLINE OPERATIONS, SOUTHWEST AIRLINES CO.

Page 2

ZONING:

State Land Use District: Urban  
City and County of Honolulu LUO: Industrial (I-2)

LAND TITLE STATUS:

Non-Ceded - Section 5(a) lands of the Hawaii Admission Act  
DHHL 30% entitlement lands pursuant to Hawaii Admission Act YES \_\_\_ NO X

CURRENT USE STATUS:

Land presently encumbered by Governor's Executive Order No. 3201, dated June 8, 1983, setting aside 3,152.177 acres designated as Daniel K. Inouye International Airport under the control and management of the State of Hawaii, Department of Transportation, for Airport Purposes.

CHARACTER OF USE:

Southwest Airlines will use the spaces for the installation of six (6) Avigilon cameras at Gates E1, E3, E5, E6, E7 and E9 for its airline operations at Daniel K. Inouye International Airport.

COMMENCEMENT DATE:

Upon execution of the revocable permit.

MONTHLY RENTAL:

\$150.00 (as determined from the Department of Transportation schedule of rates and charges, established by appraisal of Airports property statewide).

SECURITY DEPOSIT:

\$450.00, or three (3) times the monthly rental in effect.

DCCA VERIFICATION:

Place of business registration confirmed:	YES <u>X</u>	NO ___
Registered business name confirmed:	YES <u>X</u>	NO ___
Good standing confirmed:	YES <u>X</u>	NO ___

BLNR – ISSUANCE OF A REVOCABLE PERMIT FOR THE INSTALLATION OF SIX (6) AVIGILON CAMERAS AT GATES E1, E3, E5, E6, E7 AND E9 AS PART OF ITS AIRLINE OPERATIONS, SOUTHWEST AIRLINES CO.

Page 3

CHAPTER 343, HRS - ENVIRONMENTAL ASSESSMENT:

The environmental impacts of the proposed action to the subject land area are covered by the Honolulu International Airport Master Plan Update and Noise Compatibility Program Environmental Assessment (EA), State Project No. AO1011-03. The EA is a joint State and Federal document, dated September 1989 and published in the October 23, 1989 issue of the OEQC Bulletin. Accordingly, relevant mitigation from the EA and Department of Transportation environmental best management practice will address minimal impacts from this action.

REMARKS:

In accordance with Section 171-55, HRS, relating to Permits, the Department of Transportation proposes to issue a month-to-month revocable permit to Southwest Airlines for the installation of six (6) Avigilon cameras at Gates E1, E3, E5, E6, E7 and E9 as part of its airline operations at the Airport. Southwest Airlines is a signatory airline carrier with airline operations located mainly within the Overseas Terminal.

RECOMMENDATION:

Based on this submittal, and testimony and facts presented, the Department of Transportation recommends the Board finds that approving the issuance of a month-to-month Revocable Permit to Southwest Airlines, including its conditions and rent, will serve the best interests of the State.

Respectfully submitted,



EDWIN H. SNIFFEN  
Director of Transportation

APPROVED FOR SUBMITTAL:



DAWN N. S. CHANG  
Chairperson  
Board of Land and Natural Resources



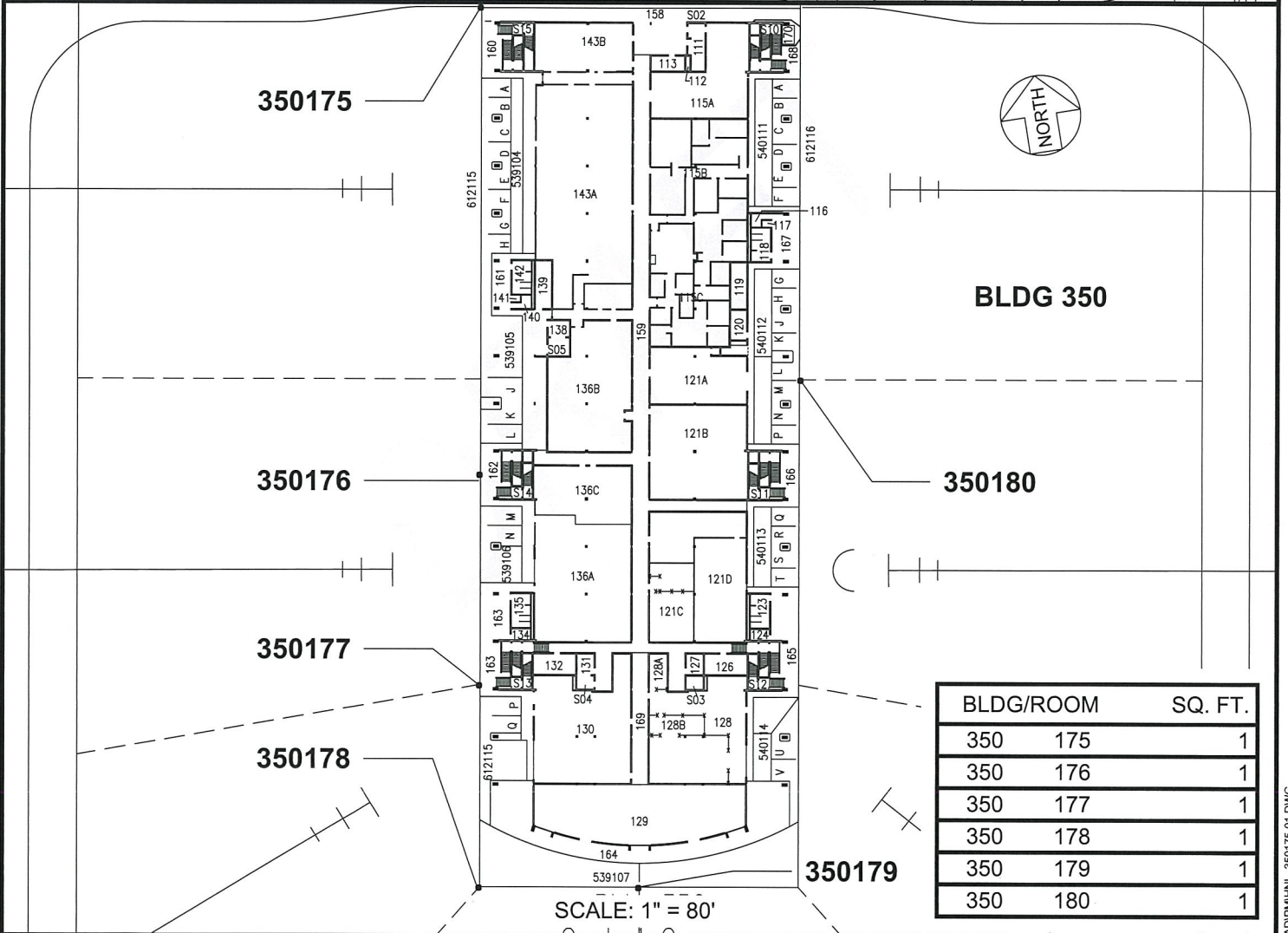
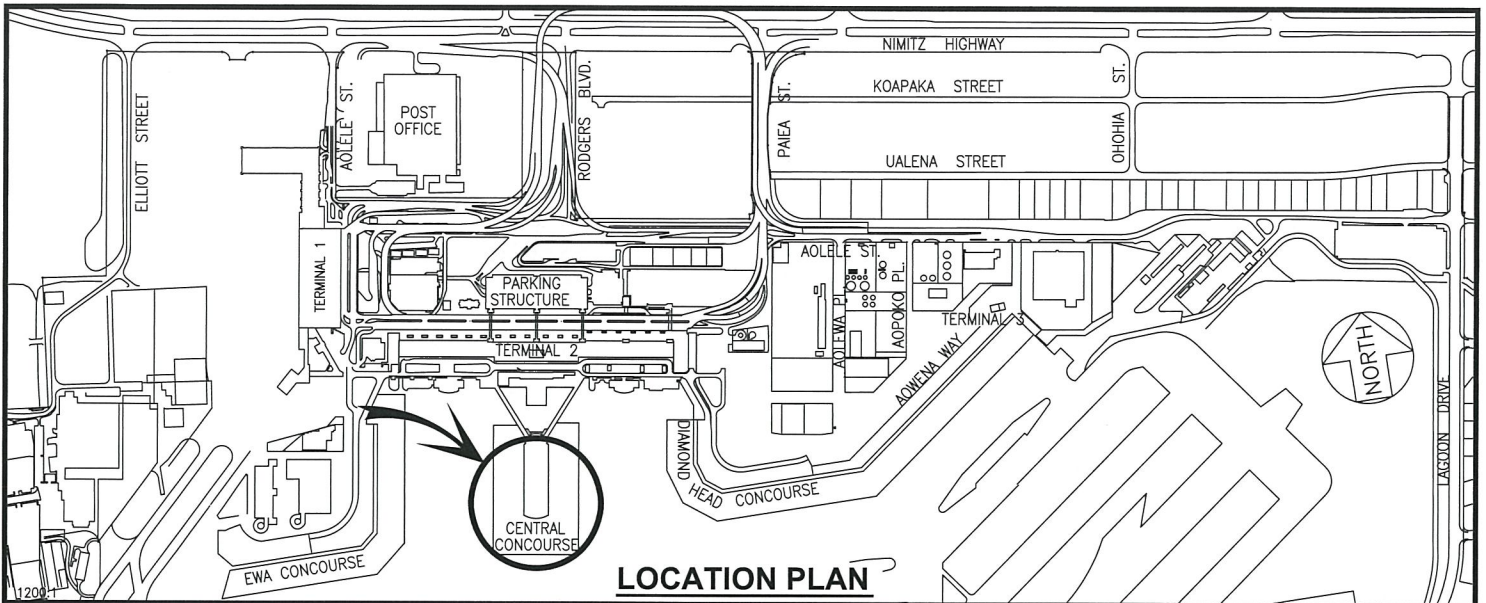

RP-9396

DATE : FEBRUARY 2023

EXHIBIT: **A**



**SOUTHWEST AIRLINES CO.  
(CAMERAS)**

**BUILDING 350  
CENTRAL CONCOURSE  
GROUND LEVEL**

**350175-180  
PLAT A1**

**DANIEL K. INOUE INTERNATIONAL AIRPORT**

N:\AIRPORTS\HNL\_HONOLULU\CAD\PM\HNL\_350175-01.DWG